

# User Manual

## OXE Gepard

## Introduction

---

Thank you for choosing this camera. The camera is specially used to record activities of wild animals. For your easier use of it, the user manual contains full specifications of operation. Please carefully read the manual before using, and keep it at a safe place for future reference.

The compilation of the user manual refers to the latest information. The manual quotes captured screen displays and graphics, with the aim to introduce the digital camera through detailed and direct methods. Due to the differences of technical R&D and production batch, those captured screen displays and graphics indicated in the manual may be different from that of actual digital camera.

## Precautions

---

### Instructions for using the memory card

- In case of a newly purchased memory card for the first time use, or data available in the memory card unrecognized for the camera or image captured by other cameras, please ensure to firstly format the memory card;
- Before plugging in or out the memory card, please firstly disconnect power supply of the camera;
- After using for many times, performance of the memory card will be lowered. In case of lowered performance, a new memory card is needed to purchase;
- The memory card is a precise electronic device. Please don't bend it and keep it away from falling or heavy load;
- Don't keep the memory card in the environment with strong; electromagnetic or magnetic field, like the place near speaker or receiver of TV;
- Don't use or keep the memory card in environment with over high or low temperature;
- Keep the memory card clean and away from contacting liquid. In case of contacting liquid, please dry it with soft cloth;
- In case of keeping the memory card idle, place it into the card sleeve;
- Please note that the memory card will get hot after long-term use, and this is normal;

- Don't use the memory card having used on other digital cameras. If to memory card on this camera, please firstly format it with the camera;
- Don't use the memory card having formatted on other camera or card reader;
- In case of one of the followings with the memory card, the recorded data may be damaged:
  - Improper use of the memory card;
  - Disconnect power supply or take the memory card out during recording, deleting (formatting) or reading;

Appearance (OXE Gepard)

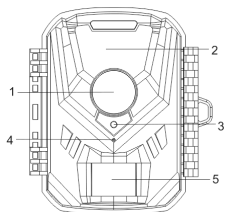

Appearance (OXE Gepard)

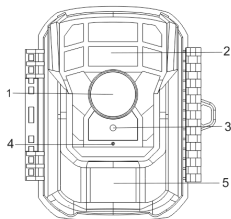

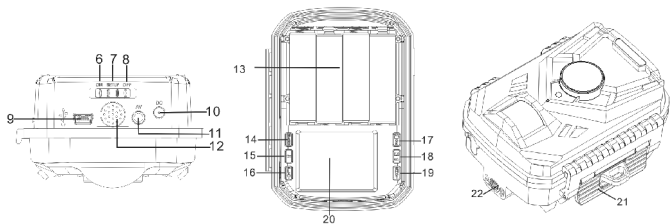

- |                  |                      |                    |
|------------------|----------------------|--------------------|
| 1. Lens          | 2. Infrared LEDs     | 3. Indicator light |
| 4. MIC           | 5. PIR Motion Sensor | 6. ON              |
| 7. SETUP         | 8. OFF               | 9. USB jack        |
| 10. DC jack      | 11. AV jack          | 12. Speaker        |
| 13. Battery slot | 14. MENU             | 15. Left           |
| 16. Replay       | 17. OK               | 18. Right          |
| 19. Shot         | 20. LCD              | 21. Catch block    |
| 22. Bracket hole |                      |                    |

## Key Functions and Indicators

Keys	Functions
MENU Key	Open or exit from menu
PLAY Key	Review photos and videos
Left Key	1. In the Settings menu, set the up key
	2. switch previous file
Right key	1. In the Settings menu for the down key.
	2. switch Photo mode
SHOT	Video recording/capturing;
OK	1. OK key          2. switch video mode

## Getting started

---

### 1. Battery/Adapter

Please make sure to place batteries in the camera before using.

1.1 Find the battery box of the camera, put into the 4x1.5V battery, and ensure the correct polarity of the battery

1.2 When using the power adapter (optional), find the DC socket at the bottom of the camera or the rubber seal ring and open it, then connect the power adapter to the power supply

## 2. Inserting memory card

2.1 Insert the memory card as indicated by the icon into the slot until the card totally inside.

2.2 To remove the memory card, gently press the edge of the memory card until it pops out.

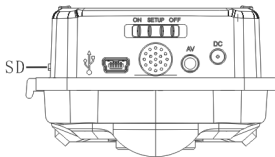

Note: The camera doesn't have built-in memory. A memory card must be inserted into the camera before using. After inserting the memory card, make sure to format the memory card on the camera first.

## System settings

---

### 1. Power on and off/ System settings

After the battery is put into the battery, push the mode switch to the "SETUP" mode and set it. In the test mode, the infrared lamp is closed.

1.1 To put the operating mode selector switch from "OFF" to "SETUP", the camera is on.

1.2 Switch between photo and video mode by pressing the ok key or

right-click

1.3 Press the MENU key to open settings menu. Press OK to confirm the setting changes.

1.4 Press the MENU key one more time to return to previous menu or exit the menu settings.

1.5 Put the operator mode selector switch to "OFF" to power off the camera.

## **2. Working modes**

There are three working modes in the camera: Photo mode, Video mode, Photo+Video mode.

### **2.1 Photo mode**

Select a photo size: 1MP, 3MP, 5MP, 8MP, 12MP,16M. The larger the file size is, more detailed the photos are. However, the larger size files take more memory space to store.

### **2.2 Video mode**

Select the video resolution: 1920X1080.1280X720.720X480.640X480. The higher the resolution is, more detailed the videos are. However, the larger size files take more memory space to store.

### **2.3 Photo+Video mode**

In Photo+Video mode, the camera first takes a photo and then starts filming video.

Note: when the machine is working in "setup" mode, and has not operated the machine for more than a certain period of time, in order to save electricity, the machine automatically shuts down, the user can click any key to open the screen, restore the display.



### **3. Video length**

The video length is optional between 1-60seconds or 1-10 minutes. The longer the recording time selected, the shorter the operating time is. The preset video length is 5 seconds.

### **4. Shot lag**

The shot lag time can be selected between 5S-60 minutes. During the selected interval, the camera will not record any images or videos. It prevents the memory card from being filled up with too many recordings of the same event.

### **5. Sensitivity of the motion sensors**

The sensitivity of the main motion sensor is set here. For interior areas and environments with little interference, select “High”. Select “Medium” for exterior areas and environment with a normal amount of interference, and select “Low” for a environment with a high level of interference.

### **6. Target recording time**

Here is to set the target recording time of the camera. Press “MENU” to find “Target recording time”. Press “OK”, and then select “ON” to set the starting working and ending working time. After finishing setting, the camera only works during the setting time every day. Beyond the period, the camera is in standby.

### **7. Time lapse**

Here to set Time lapse shooting. Press “MENU” to find “Time lapse”. Press “OK”, then select “ON” to set the time interval, and set the values of Hr, Min and Sec. For example, if the process of flowers

blooming has to be recorded, time lapse can be used. The camera automatically takes pictures in every setting time interval.

## 8. Time&Date

Open menu key to select time and date, then press "OK" Key to set Set the time and date format: adjust the corresponding time date according to local time, press left / right to modify the size of the value, press the "ok" key to switch to the next location to be modified, and press the "menu" key to exit after setting up

Time format: 12/24hr

Date format: dd/mm/yyyy, yyyy/mm/dd, mm/dd/yyyy ;

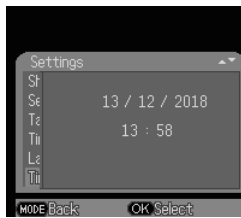
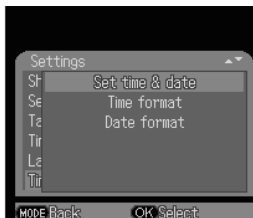

## 9. Password protections

Set the camera boot password, open the menu to select password protection, and then press the "OK" key. then set a 4-digit combination password between digit 0-9. If you forget the boot password, when the camera is off, ,press and hold "menu"& "replay" button together, then set the mode key to "test" mode, the camera will be unlocked.

## **10. Serial numbers**

To set a unique serial number for the camera, open the menu to the serial number and press the "OK" key, switch to set the "on", set a serial number of the 4-digit combination of 0-9 or the letter.

## **11. Playback**

Take down the camera from where it's fixed. Slide the operating mode selector switch to the "SETUP" position. Press playback key and Left/Right key to review the photos/videos. While reviewing photos, press Left/Right key to page up/down. While reviewing videos, press OK key to start playing, press OK one more time to stop. Press Playback key to return into standby.

### **11.1 delete current file**

Using this feature, you can delete the currently selected picture or video from the camera memory card. In playback mode, press the "MENU" key, select "delete the curren document", press ok to confirm, press right key to select "Delete" again, press the "OK" key to confirm the deletion of the file

### **11.2 delete all file**

With this feature, you can delete all pictures or videos from the camera memory card. In playback mode, press the menu key, select "Delete all documents", press ok to confirm, and right-click "Delete" to confirm the deletion of the file again by pressing the ok key

### **11.3 Activate slide show**

This function can be used to play back the photos stored on the memory card automatically. Each photo is shown for about 2 seconds.

To stop the slide show and keep the current image permanently on the screen, press the OK button.

#### 11.4 Write protection

This function can be used to protect individual recordings of all saved recordings from accidental deletion.

Select “Write-protect current file” to protect the currently selected recording from accidental deletion.

Select “Write-protect all files” to protect all saved recordings from accidental deletion.

Select “Unlock current file” to remove the write protection for the currently selected recording.

Select “Unlock all files” to remove the write protection for all saved recordings.

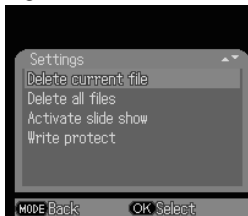

## Operating Principle

---

### 1. Aligning the camera

In test mode you can work out the optimum exposure angle and the range of the motion sensor.

1.1 During alignment consider whether the use of the side motion sensors may be useful for attaining the desired observation results.

1.2 Align the camera as follows:

Fasten the camera to a tree or similar object at a height of 1-2 meters and align the camera in the desired direction. Then move slowly from one side of the target area to the other side. While doing this, monitor the motion display.

1.2.2 If this lights up in blue, you have been detected by one of the activated side motion sensors. If it lights up in red, you have been detected by the front motion sensor. In this way, you can work out the best alignment for the camera.

1.2.3 The motion display only lights up when operating mode selector switch is in the TEST position and one of the motion sensors has detected movement. During normal operation, there will be no LED display in this area.

1.2.4 To ensure that the camera doesn't make unwanted recordings of irrelevant movements, it should not be set up in a sunny location or close to branches. The detecting range of the sensors is 80°. And the recording angle of the camera is about 90°.

## **2. Normal working mode**

In this mode, recordings are triggered via the motion sensors.

To set live mode, slide the operating mode selector switch to the "ON" position. After 15 seconds, the LED of motion display will go off.

Then the camera will start to operate independently and will go into standby mode. As soon as any wild animals or similar enter the detecting range of the side motion sensors, the camera will be activated and detect the motion. If the wild animal keeps moving to the detecting range of the central sensor zone, the camera will start capturing photos and/or videos (depending on the configuration). After the wild animal moves out of the detecting range of side motion sensors, the camera switches off and goes back into standby mode.

### **3. Night working mode**

3.1 During night exposures the infrared LEDs on the front of the camera provide the required light for taking pictures. The range of the LEDs makes the camera to shooting pictures within 3m-20m. However, reflective objects can cause overexposure.

3.2 Please note that pictures taken in night exposures are black and white. When recording a video for a long time, the low voltage may have great influence on the stability of the camera. So in case of the low voltage, it better not to record in the evening.

## **Videos/photos/dates output**

---

### **1. TV connections**

The camera can transfer the video signal to an external monitor or the video input of a television set. Please also follow the instructions of the respective playback device.

1.1 Open the TV, connect the TV with the camera through date cable

1.2 Open the camera, and slide the operating mode selector switch to “SETUP”

1.3 After connecting, the camera enters the mode of playback and the LCD turns off. What the camera captured would be shown on the TV.

## **2. Transferring recordings to a computer**

Connect the camera with the computer through the cable. After successful connection, there would appear a new driver named mass storage on the computer. Photos and videos can be found in “DCIM/100MEDIA” in the mass storage and can be copied to the computer.

 **Note:** In case of data loss, please don't disconnect the cable or take out the memory card when copying photos/videos.

## Technical Specifications

Image sensor	2MP CMOS sensor
Function modes	Video recording/Photo/Playback
Lens	F2.3 f=3.8mm
LCD	2.0 inch LCD
Photo resolution	16M(4068x3456),12M (4000 x 3000), 8M (3264 x 2448), 5M (2592 x 1944), 3M (2048 x 1536),1M(1280 x 960)
Video resolution	1920x1080, 1280X720, 720X480,640X480
Memory type	TF card(up to 32GB max)
Format	JPEG, AVI
USB connection	USB 2.0
Power supply	6V
language	English/French/Spanish/German/Portuguese/ Italy/Chinese
OS	Windows XP/Vista/7/8, Mac 10.2
Dimension	108.5x75.5x46mm

Note: Specification could be subject to modification due to updating.  
Please regard the actual product as the standard form.





Contact: [oxe@oxe.cz](mailto:oxe@oxe.cz)

Web sites: [www.oxe.cz](http://www.oxe.cz)

Importer:

Stasanet DOO  
Vojvode Hrvoja 28  
Beograd  
Srbija  
[www.stasanet.rs](http://www.stasanet.rs)

Declaration of conformity with Directive 1999/5 / EC

The manufacturer hereby declares under his responsibility that this product is in full compliance with the requirements and requirements of Directive 1999/5 / EC.

CE and RoHS certification protocols are available from the distributor.

